

RS100 PUMP-OUT PEDESTAL

ROLEC
Global Marina Services



The RS100 PUMP-OUT Range

The RS100 is a low cost, self-contained sanitation solution, ideal for marinas and waterside locations.

PRODUCT FEATURES

- Hot-dipped galvanised steel internal chassis
- UV stabilised external shell and shell material variants: steel, composite or aluminium
- Sewage and sea water resistant materials
- 360 degree low energy LED lighting c/w with pump-out signs on lens
- 10m ship-to-shore hose
- 30 minute run-dry safety failure
- Valve operated euro-probe c/w optical viewing lens
- Built-in variable setting pump-out timer, non-return valve and electrical protection switchgear
- The range consists of free-to-use or pay-to-use options
- Easy to install



10m
Hose



UV
Stabilised



CE
Certified



IP65
Weather Proof



LED
Illumination



Strong
& Durable

SPECIFICATIONS

CHARACTERISTICS

Materials	Head: ABS Granulate Natural Polyethylene Body Internal: Hot-Dipped Galvanised Steel Body External: Powder Coated Aluminium / 304 Stainless Steel BS EN-10204:2004, BS EN 573-3:2013, BS EN 755-2:2016
Dimensions	480mm x 1255mm x 480mm (W x H x D)
Operating Temperature	-30°C to +60°C (Installed and Operated Within Multiple Climates from Around the Globe)
IP Rating	Pedestal Rated IP65
Compliances	BS7671 Wiring Regulations BS EN 61439-2:2011, BS EN 61439-5:2015 CE Certified Low Voltage Directive 2014/35/EU Electromagnetic Directive 2014/30/EU Corrosion Resistant / Salt Mist Tested Panels ISO 9227 UV Stabilised Flame Retardant to UL94
CE	
Typical Weight (AVG)	40kg (Including Pump) 17.5kg (Pump Only)

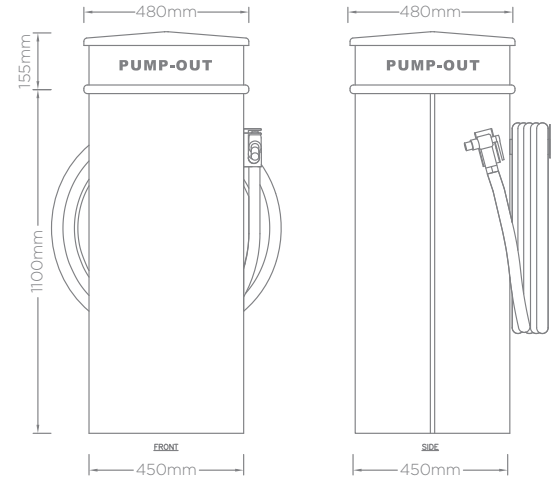

ELECTRICAL

Voltage	230v or 400v (1Ø or 3Ø)
Overload & Fault Current Protection	MCB/RCD or RCBO IEC 60898-1/IEC 61009-1/IEC 61009-1

PUMP

Type	RS100
Pressure	Maximum Operation Pressure 1.6 Bar
Protection	Motor-rated Overload Protection
Voltage	230v and 400v (1Ø or 3Ø)
Weight	17.5kg
Protection Valve	In-line Non-return Valve
Pumping Distance	100m Nominal
Suction	Horizontal: 25m Vertical: 4m
Flow Rate	Up to 80 l/min at 0 meters with clean water (Flow rate will decrease in line with water viscosity and lift)
Ports	Inlet Port: 38mm (1.5") Outlet Port: 38mm (1.5")
Maximum Soft Solid Size	8mm

LIGHTING

Type	360 Degree Low Energy LED
Rating	4300k 4x1 Watt
Protection	6amp RCBO

OPTIONS

- Shell colours and materials
- Branding vinyls
- Payment facility
- Keyswitch control

Images are for marketing purposes only and are not contractual © 2017



Head office contact:
 t: +44 (0) 1205 724754
 f: +44 (0) 1205 724876
 rolec@rolecserv.co.uk

Rolec Services Ltd
 Ralphs Lane, Frampton West
 Boston, Lincolnshire
 UK. PE20 1QU

MSDS-0021 (V2)

 @RolecMarina
www.rolecserv.com