

# MARINA FIRE CADDY

## INSTALLATION & OPERATION MANUAL



**ROLEC**  
*Marina Services*

## Amendments

Amendment Number	Details	Date
Ver 2, Rev 0	New Document.	January 2021
Ver 2, Rev 1	Consolidation of minor changes across all manuals	December 2021

<b>Product:</b>	<b>Fire Caddy</b>	
<b>Applicable Models:</b>	EEAI0010	
<b>Document Type:</b>	Operation and Maintenance Manual	
<b>Document Code:</b>	MSDSM-01-V02-R1	
<b>Language:</b>	UK English (Original)	
<b>Date Published:</b>	December 2021	
<p>Rolec Services Ltd are the publishers of this document and own the rights to use the text, images and all technical content contained within. Content supplied by third parties / partner organisations remains the property of that organisation and is used by agreement with the supplier.                  Rolec Services Ltd exercise care to ensure content is as accurate as possible at the time of publication. However, no guarantee of accuracy should be inferred.</p>		
<p>Rolec Services Ltd, Ralphs Lane, Boston, Lincolnshire PE20 1QU, United Kingdom.                  +44 (0) 1205 724754                  rolec@rolecserv.co.uk</p>		



## Contents

<b>Contents</b>	<b>2</b>
<b>Safety</b>	<b>3</b>
Safety Advice within this Manual	4
<b>Product Overview</b>	<b>4</b>
<b>Product Specification</b>	<b>6</b>
Physical Specification	6
Engine Specification	6
Pump Specification	6
Labelling	7
<b>Unpacking</b>	<b>7</b>
<b>Before Use</b>	<b>8</b>
<b>Operation</b>	<b>8</b>
<b>Maintenance</b>	<b>10</b>
<b>Third-Party Manufacturers Manuals</b>	
Engine	
Pump	

## Safety

This manual is specifically applicable to the Fire Caddy product and is provided as a guide to its operations and maintenance.

This manual combines manuals provided by third-party component manufacturers.

	<b>IMPORTANT:</b> End Users must <b>read</b> and <b>understand</b> the content of this manual before installation/use.
	<b>WARNING: Liquid Fuel</b> To operate, this equipment requires liquid fuel. Make sure the equipment and fuel is stored in an appropriate manner to minimise any risk of fire.
Operators of the Fire Caddy product must be trained and proficient in the use of the equipment. <ul style="list-style-type: none"><li>• Rolec Services Ltd cannot accept any responsibility for problems arising from improper use.</li></ul>	
<b>NOTE:</b> Damage to the equipment, connected systems or to property caused by improper use are the responsibility of the user.	

- The information provided in this manual must ONLY be used with the model(s) listed on page 1 of this manual.
- The information provided in this manual must NOT be used with any other product.
- The content of this manual may be updated as required.
- Do NOT use the equipment for anything other than its intended purpose.
- Do NOT modify the equipment unless specifically instructed to do so by the manufacturer.

## Safety Advice within this Manual

Rolec manuals use a system of warnings, cautions and notes.

- **WARNINGS** concern the safety of users and will be given before the detail/instructions in the manual.
- **CAUTIONS** concern the potential for damage to the equipment and will be given before the detail/instructions in the manual.
- **NOTES** are given to provide additional information and/or highlight information of importance. They will be given either before or after the detail/instructions as appropriate and may use different wording (such as IMPORTANT) where emphasis is required.

Warnings, Cautions and Notes may be repeated several times as appropriate and may be preceded by a hazard symbol.

## Product Overview

The Rolec Fire Caddy is a mobile fire-fighting unit which uses sea/river water (which may be mixed with a foaming agent) to fight the fire; eliminating the need for expensive pipe work systems.

- Easily manoeuvrable portable unit with rugged 'go anywhere' wheels.
- Hot dipped galvanised steel framework, powder coated.
- Honda petrol engine with 1 hour running time on a full tank.
- Mixes sea or river water with concentrate to project a biodegradable fire-fighting foam.
- Projects water or foam from the end of the hose to give a maximum 35m range from the fire caddy\*.
- Delivers water foam at a rate of 400 litres per minute.
- 3m water inlet pipe complete with filter and 20m of Ø52mm lay flat fire-fighting hose with spray nozzle (foam branch pipe).
- Variable mix valve to increase foam concentration 1-6%.
- Quick assembly pipe couplings.
- Protective storage cover.

\* Maximum range depends on the height the fire caddy is, above the water being used as the supply. Greater height = shorter range.

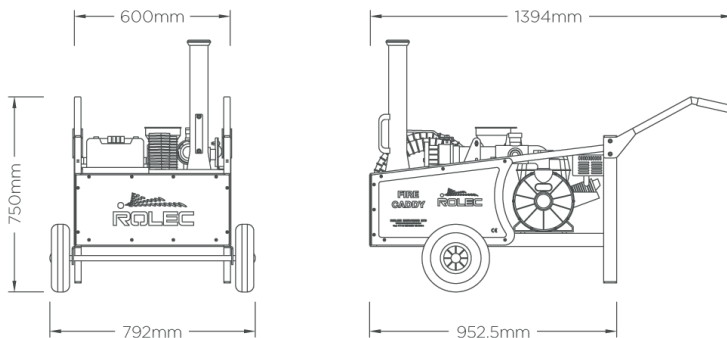
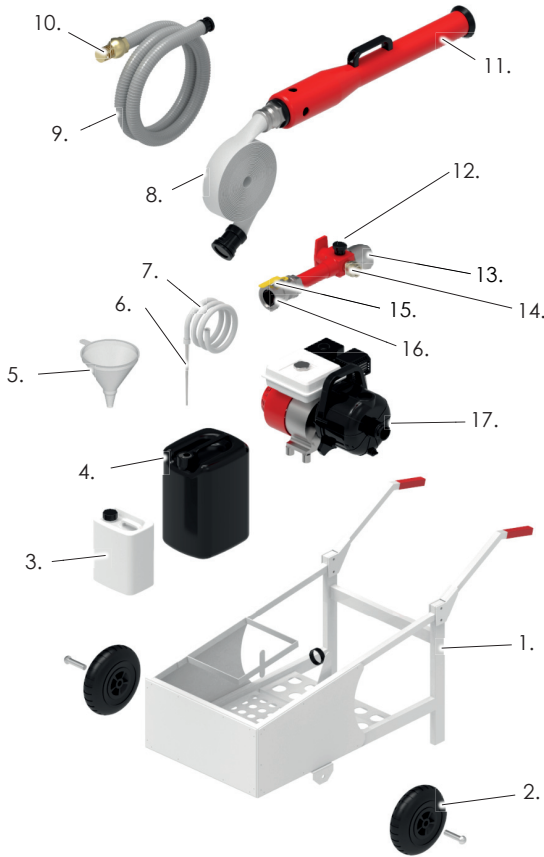

Figure 1 Fire Caddy Dimensions

**NOTE:** Spray nozzle is laid flat when in storage.



**Figure 2 Fire Caddy Components**

- |                           |  |                                   |
|---------------------------|--|-----------------------------------|
| 1. Frame assembly         | 7. Foam inductor hose                                  | 13. Inductor                      |
| 2. Wheel assembly         | 8. Industrial hose fitted with Storz couplers (10 bar) | 14. Foam inductor hose coupling   |
| 3. Pump priming container | 9. Suction hose  | 15. Isolation valve               |
| 4. Foam charge container  | 10. 2" foot valve                                      | 16. 2" Storz coupler, male thread |
| 5. Plastic funnel         | 11. Foam Branch Pipe (Nozzle)                          | 17. Engine / Pump                 |
| 6. Foam cap dip tube      | 12. Foam % control                                     |                                   |

**NOTE:** Caddy cover not shown.

## Product Specification

### Physical Specification

<b>Dimensions</b>	1394 x 792x 750mm (LxWxH)
<b>Material</b>	<b>Frame:</b> Hot Dipped Galvanised Powder Coated Steel <b>Protective Cover:</b> Polyester with PVC Coating
<b>Mass</b>	80kg (Without Fuel & Foam Mixture) 115kg (Maximum)
<b>Operating Temperature</b>	-30°C to +60°C (Installed and Operated Within Multiple Climates from Around the Globe)
<b>IP Rating</b>	IPX6
<b>IK Rating</b>	IK10 Chassis

### Engine Specification

<b>Manufacturer</b>	Honda
<b>Type</b>	GX160 Air Cooled 4-Stroke OHV
<b>Power Output</b>	4.8HP (3.6kW) @ 3,600RPM
<b>Carburettor</b>	Butterfly
<b>Starting System</b>	Recoil
<b>Lubrication System</b>	Splash 0.6 Litre
<b>Fuel</b>	Unleaded 86 Octane or Higher
<b>Fuel Use</b>	Approximately 1.73 Litre/hr (@ 3,600RPM)

### Pump Specification

<b>Manufacturer</b>	Duel Pacer
<b>Type</b>	S Series SE2UL (DPF26P)
<b>Material</b>	Corrosion Resistant Polyester
<b>Inlet / Outlet</b>	2.0" / 2.0"
<b>Flow</b>	Pump only - 757 l/min (166 UK gal/min or 200 US gal/min) With foam branch pipe fitted - Approx. 450 l/m (99 UK gal/min or 120 US gal/min)
<b>Hoses</b>	<b>Suction Hose:</b> 3m With Filter <b>Delivery Hose:</b> 20m Ø52mm Lay Flat

## Labelling

Users must observe the information given on labels to ensure safe use of the product. Labels may be in the form of adhesive 'stickers', plates, and/or moulded into the surface of components.

Refer to the labels shown on the equipment and in the third-party manufacturer's documents incorporated into this manual.

## Unpacking

The content of the package depends on any options or accessories.

**IMPORTANT:** Make sure all packaging is disposed of responsibly and in accordance with the current regulations in your region.

**WARNING: Lifting Hazard**

Due to the weight of the Fire Caddy equipment, two (or more) people will be required to lift the apparatus from the delivery pallet.

1. Make sure the pallet (complete with Fire Caddy) is on firm level ground and that the Fire Caddy cannot roll off the pallet when the securing straps/banding is removed.
2. If present, remove any outer coverings, plastic sheets, etc protecting the package.
3. Remove the straps/banding securing the Fire Caddy to the pallet.
4. If present, remove any further coverings, plastic sheets, etc protecting the package.
5. Fold each of the handles upwards and secure in their 'in use' position with the pins provided.
6. Carefully remove the Fire Caddy from the pallet:
7. Remove the loose equipment from the Fire Caddy and check it is all in serviceable condition and/or has not been damaged in transit.



**NOTE:** The Fire Caddy is supplied with a solution of foaming concentrate which is mixed with water as it flows from the nozzle. Further supplies of foaming concentrate are available from Rolec Services Ltd.



## Before Use

1. Make sure to read and understand the **Engine** and **Pump** manufacturer's operating instructions that follow the Rolec section of this manual.
2. Make sure the engine's fuel tank is full.
3. Make sure the engine's oil level is correct.
4. Fill (prime) the pump with fresh water until it reaches the correct level.
5. Make sure the foam dip tube is in place.
6. Make sure the foam percentage control is set to 6%.

## Operation

	<b>WARNING: Liquid Fuel</b> To operate, this equipment requires liquid fuel. Make sure the equipment and fuel are stored in an appropriate manner to minimise any risk of fire.
	<b>WARNING: Liquid Fuel</b> Do NOT fill the engine fuel tank when the engine is running or is hot. Stop the engine and wait for the engine to cool.
	<b>IMPORTANT:</b> End Users <b>must</b> read and <b>understand</b> the content of this manual before installation and/or use of the product.
Operators of the Fire Caddy product must be trained and proficient in the use of the equipment. <ul style="list-style-type: none"> <li>• Rolec Services Ltd cannot accept any responsibility for problems arising from improper use.</li> </ul>	
<b>NOTE:</b> Damage to the equipment, connected systems or to property caused by improper use are the responsibility of the user.	

1. Remove the Fire Caddy cover.
2. Open the top cap on the pump (marked **Priming Water Only**)
  - Make sure the priming container is full of water.
  - Using the funnel, pour the full amount into the pump then replace the cap securely.
3. Move the Fire Caddy in a safe manner towards the site of the fire.
4. Position the Fire Caddy at a safe distance from the fire and in a safe location that offers protection from the fire and which will allow personnel to escape if required.
5. Remove and uncoil the suction hose from the trolley and attach one end to the quick release coupling on the side of the pump casing.  
 Drop the other end (with the strainer attached) into the water supply. Make sure it remains under the water.

6. Unroll the fire hose:
  - Attach the Foam Branch Pipe to one end of the fire hose.
  - Attach the other end of the fire hose to the coupling on the trolley.
7. Make sure the isolation valve is in the closed position.
8. Start the engine (refer to the information below for engine starting).
9. When the engine is running, move the throttle lever to the normal running position.
  - Water should now have filled the pump and the outlet tube.
10. Open the isolation Valve on the top of the trolley to allow the delivery hose to fill with water.
  - The foam /water solution should now be discharged.

## Maintenance

**WARNING: Flammable Fuel**

Do NOT maintain the engine when it is running or is hot. Stop the engine. Wait for the engine to cool before adding fuel or performing maintenance.

1. Refer to the maintenance schedule below and in the manufacturers documents that follow:

Serial	Task	Maintenance Interval				
		Before Use	After Use	3 Months	6 Months	12 Months
1	Check/replenish the fuel level	X	X	X		
2	Clean the fuel sediment cup				X	
3	Check/replenish the engine oil (Refer to engine manual)	X	X	X		
4	Change engine oil (Refer to engine manual)				X	
5	Flush the pump system with fresh water then replenish ready for next use	X	X	X		
6	Check the priming kit		X	X		
7	Check engine air filter element. Clean/replace if required (Refer to engine manual)			X		
8	Replace engine air filter element (Refer to engine manual)					X
9	Check/adjust spark plug gap (Refer to engine manual)				X	
10	Replace spark plug (Refer to engine manual)					X
11	Check/adjust engine idle speed (Refer to engine manual)					X
12	Check/adjust engine valve clearances (Refer to engine manual)					X
13	Examine the hose pipes and hose fittings for damage and correct fitment	X	X	X		
14	Check for oil and fuel leaks	X	X	X		
15	Check wheels and tyres are in a good condition and are free running.			X		
16	Start the engine and ensure it runs smoothly			X		
17	Perform a Fire Caddy drill to ensure equipment is in full working order and to personnel adequately trained			X		
18	Flush the Fire Caddy through with clean water		X	X		
19	Examine the Fire caddy for corrosion. Treat as required			X		
20	Thoroughly clean the Fire Caddy		X			
21	Replace the cover and store in a protected environment		X			
22	Clean pump water inlet and suction line filters		X			

# ROLEC

*Marina Services*

THE WORLD'S LEADING MARINA  
SERVICES SPECIALIST



Head office contact:  
t: +44 (0) 1205 724754  
f: +44 (0) 1205 724876  
enquiries@rolecserv.co.uk

 @RolecMarina  
[www.rolecserv.com](http://www.rolecserv.com)